

Temora's next generation of aged care!



Whiddon Temora
Opening 2027

Key Features

- Two Storey extension
- 92 beds
- Dementia Friendly Design
- Coffee Kiosk, Hair Salon & Gym
- Resident gardens
- Activity centres
- Unites our two Homes into one exceptional Home



Whiddon
Award-winning care

April/May 2026



Construction begins

Construction

Q4 2027



Target date for building completion

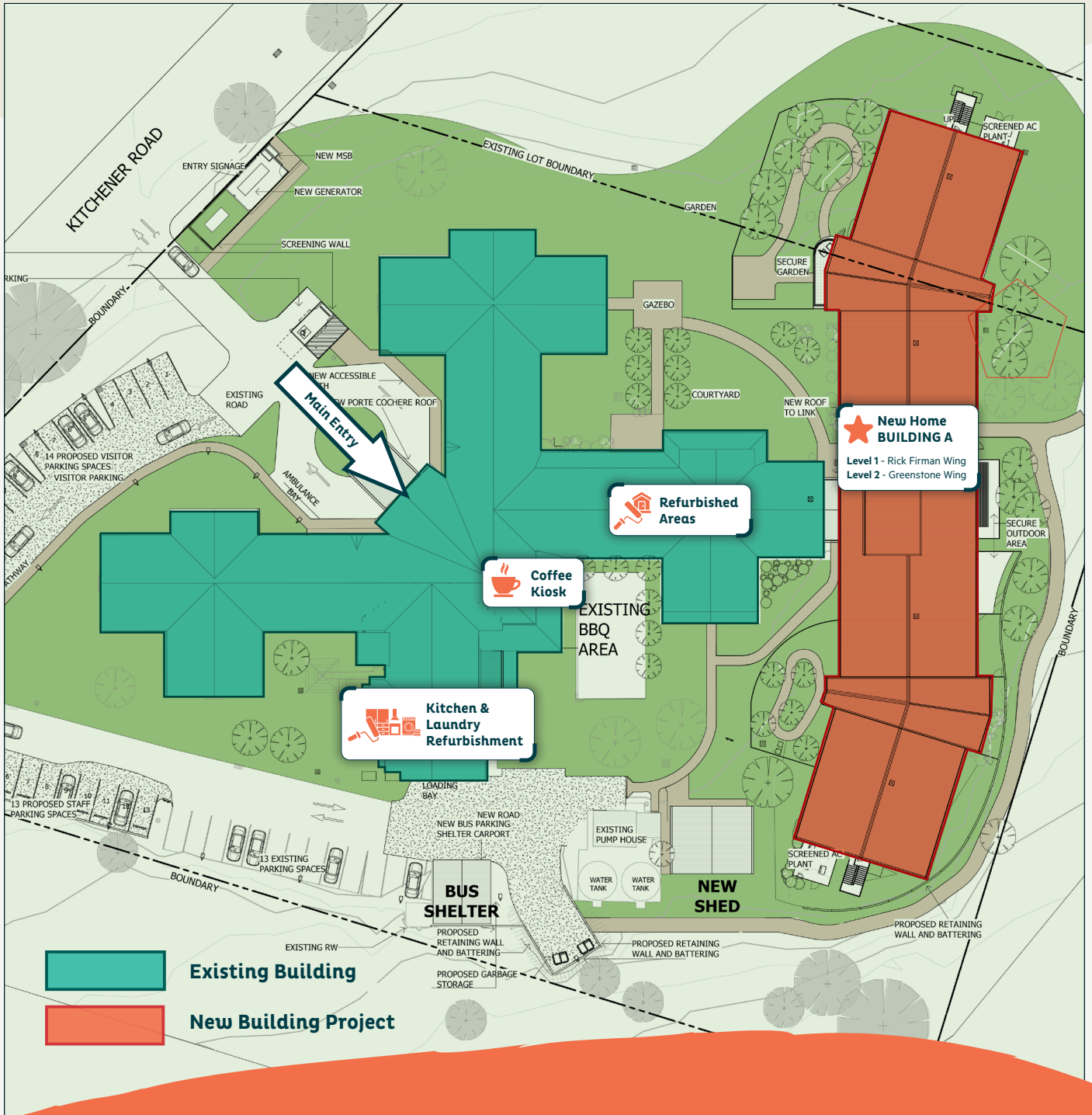

Existing Building

New Building Project